



**CITYTAPS**

**Reduce Non-Revenue Water (NRW)**

# Optimize your **REVENUE**



## CityTaps end-to-end NRW solution

Our **step-by-step approach** helps you to choose and deploy the most appropriate actions to reach your NRW reduction target.

The **modularity** of our software platform combined with an offer of hardware and services allow to **personalize each project** so that it fits your current and future needs.

**126**  
billion m<sup>3</sup>/year  
Worldwide

This is the global level of  
Non Revenue Water...

*“Do you know how many m<sup>3</sup>/year  
you lose and how much more  
revenue you could invoice?”*

CT

**1**

### Monitor and Report Water Losses

Network sectoring  
Real time flow and pressure logging  
NRW monitoring and reporting

**2**

### Reduce Physical Losses

Localisation, prioritisation and  
repair of physical losses

**3**

### Reduce Commercial Losses

Identification, analysis of  
abnormalities & inaccuracies

**4**

### Planning & Investment

Define future NRW action plan  
Estimate budget and ROI  
Find financial solutions

# WATER LOSSES

1

## 1.1

### DMA Creation

#### A. GIS update

A field collection software with **map visualisation** is used to update data from the GIS and the billing software.

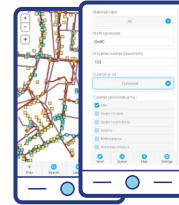

#### B. DMA sectorization

Expert Services are provided to **sectorise the network into District Metered Areas (DMA)** and verify the hydraulic model.

## 1.2

### DMA Monitoring

#### A. Bulk Meters

Ultrasonic bulk meters up to DN200 record **low and high flow-rates** with optimum accuracy at the inlet/outlet of the DMAs.



#### B. GPRS Loggers

GPRS loggers are connected to the bulk meters to **record & transmit flow & pressure** data to the DMA Monitoring module.



#### C. DMA Monitoring Module

Monitoring of flow and pressure for all DMAs available **from any computer or smart phone in real time**



## 1.3

### NRW Monitoring

#### A. NRW Monitoring Module

An **analytic** software provides:

- Monitoring of **production volume**
- Follow-up of **pressure and night-time flow**
- Detection of **bursts**
- Automatic **NRW balance** calculation including **split between physical and commercial losses**
- Reporting of all major **NRW indicators**



Reduce

## PHYSICAL LOSSES

2

90%

Physical losses  
are  
invisible

### 2.1

#### Leak Finder Module

Satellite imaging is used to pre-localize the **visible and invisible leaks** in a large area within few hours and with the highest hit rate.



### 2.2

#### Acoustic Leak Detection



Acoustic Leak Detection equipment, provided with training, allows your team to **precisely locate invisible leaks** in the field.

### 2.3

#### Leak Manager Module

A **collaborative software** optimizes all field activities from leak detection to repair to reduce leaks duration and losses.



### 2.4

#### Pressure Management Module



A solution of pressure management can be deployed to continuously optimize water pressure and **protect the assets**.



Reduce

## COMMERCIAL LOSSES

3

### 3.1

#### Commercial Loss Manager Module

A software analyses the **data from the billing database** to detect metering inaccuracies and abnormal readings.



Meter & Billing  
Data Input



Detect  
**metering  
inaccuracies**

- Poor meter **quality**
- Meter **ageing**
- Meter **blockage**
- Incorrect meter **size**

Flag  
**abnormal  
readings**

- **Excessive** water consumption
- **Zero** consumption
- **Identical** water consumptions
- **Repeated** estimates

### 3.2

#### Accurate Billing Meters

- **Ultrasonic** technology for high accuracy
- Long lifetime as **no moving part** in the water
- **No air** in pipe measured
- **Large flow range** capabilities
- **Smart** meter (wMBus or LoRaWAN) for **meter reading accuracy**

Smart  
residential meter

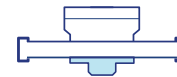

Smart  
C&I meter

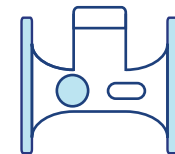

Manage

## BUDGET & INVESTMENTS

4

To reach **your objectives of NRW reduction**, we help you manage your **replacement plan and operations maintenance** to ensure an optimized return on investment.

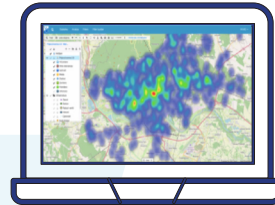

### Asset Manager Module

- **Analytics** based on leak detections and repairs
- Pipes and meters **replacement programs priorities**
- Optimized infrastructure maintenance costs
- **Calculation of budget** for replacement and maintenance projects
- Financing of **NRW investment plan**

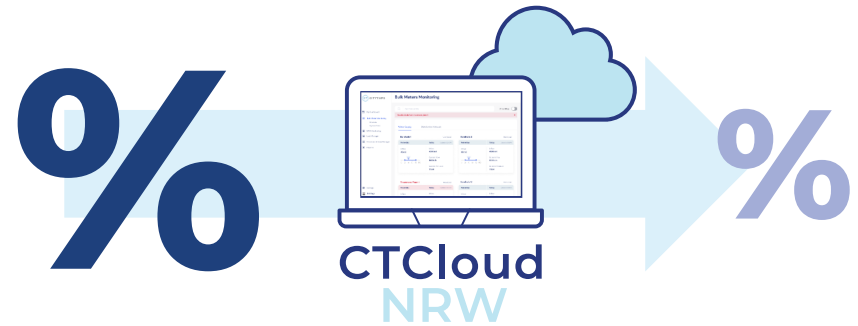

### Financing Solutions

CityTaps helps water utilities to source adequate **tailor-made financing** to invest and carry out NRW reduction programs.

Achieve

# SUCCESSFUL DIGITAL TRANSFORMATION

## Capacity Building

The CityTaps technical team, with its strong experience and knowledge of local culture, provides **customized training** to build the capacity of local water utility teams.

The local teams therefore **improve their skills and achieve autonomy** in the use of the newly deployed technologies for a successful digital transformation

## Technical Assistance

A dedicated CityTaps team provides technical assistance both in **design phase** of your NRW programs and throughout the **implementation phase**.

CityTaps experts and support team are committed to your long-term success and work with you to **ensure that NRW reduction results meet the objectives** defined in the service contract.

CityTaps teams can also **provide numerous operational services** (eg. Meter installation, remote reading infrastructure maintenance , sending SMS, etc...) allowing your teams to remain focused on their core business of water production & distribution and customer relations.

# OUR SOLUTION

## 1 Monitor & Report Water Losses

Sectoring  
Measurement  
Transmission  
Monitoring  
Reporting

## 2 Reduce Physical Losses

Pre-localisation  
Localisation  
Prioritisation  
Management & Repair  
Asset Management

## 3 Reduce Commercial Losses

Analysis  
Detection of abnormalities & inaccuracies  
Prioritisation  
Large consumer strategy

## 4 Planning & Investment

Analytics  
Replacement programs  
Prioritisation  
Budget Calculation  
Financing Solutions

### Software Platform with Multiple Modules

GIS update



DMA Monitoring



NRW Monitoring



Leak Finder



Leak Manager



Pressure Management



Commercial Loss Manager



Asset Manager



### Hardware



Bulk meters



GPRS Loggers

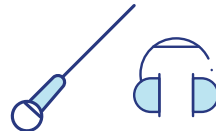

Acoustic Leak Detectors



Pressure Regulated Valve



Smart C&I meters

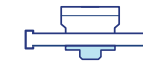

Smart residential meters

### Services

DMA Creation

Equipment Installation  
Software Integration

Financing Sourcing

Customized Training, Capacity Building & Technical Assistance



# Why **CHOOSE CITYTAPS**

Team of  
**EXPERIENCED WATER EXPERTS**

More than  
**8 NATIONALITIES**

Projects deployed in  
**11 COUNTRIES**

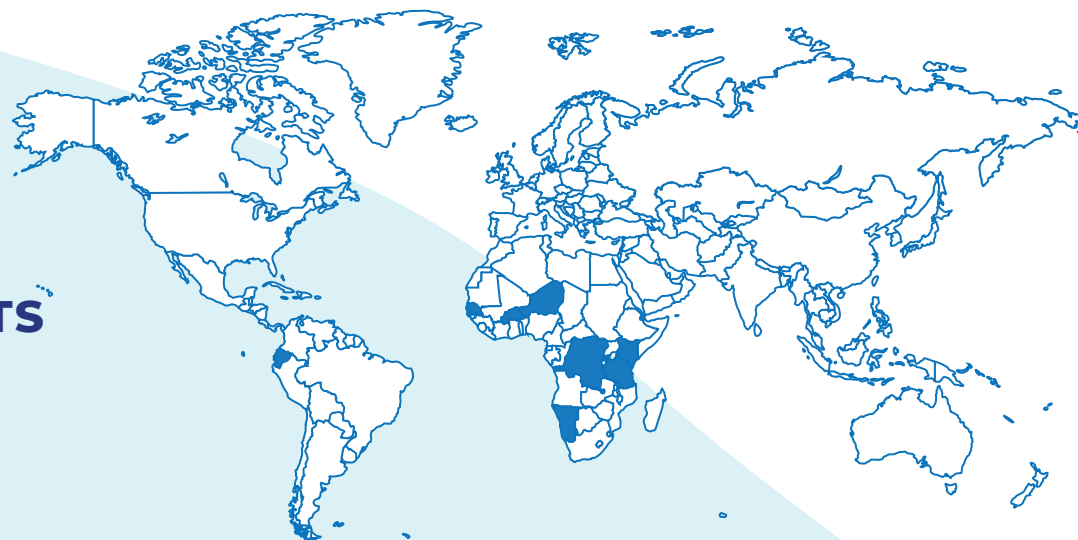

CityTaps helps bring running water to every urban home. It provides water utilities with comprehensive technological and financial smart water solutions to continually improve performance.

The company delivers evolutive Non-Revenue Water solutions that allow water utilities to build capacity and optimize their network efficiency, and patented Pay-As-You-Go technology that secures sustainable water access for the urban poor without the risk of accumulating debt.

CityTaps is committed to helping water utilities strengthen their financial health, allowing them to invest in infrastructure to connect more homes to the water supply network.

Contact us  
**[sales@citytaps.org](mailto:sales@citytaps.org)**

**CityTaps SAS**  
Schoolab  
11 rue de Milan  
75009 Paris  
France

**CityTaps Kenya**  
Laiboni Center, 4<sup>th</sup> Floor  
Lenana Road Kilimani  
PO box 100798-00101  
Nairobi, Kenya

